



## *News and Highlights*

2nd Quarter 2024

[www.co.beltrami.mn.us](http://www.co.beltrami.mn.us)

**Beltrami County Mission and Values:** We will strive to be the catalyst to firmly establish a community that promotes healthy families, environmental quality, expanding economic opportunity and a quality of life second to none.

### Jail Replacement Project Update

The Beltrami County Jail Replacement Project remains on schedule and has entered the next phase of the project. On May 21, 2024 the Beltrami County Board of Commissioners approved the architectural firm to begin the construction documents phase on May 24. Beltrami County’s contract with Klein McCarthy Architects is structured in phases that allows the opportunity to pause the project in the event it was necessary. One of the reasons for this was uncertainty over the voter approved Local Option Sales Tax implementation.

During the 2023 legislative session, the Legislature approved Beltrami County to pursue the Local Option Sales Tax to fund the new jail. Voters overwhelmingly approved the ballot question with nearly 97% of voters casting their vote in favor. The five-eighths of one percent sales tax will be implemented on July 1, 2024. It does not impact family staples such as food, clothing or shoes.

After receiving approval to collect the new sales tax to fund the project, the Beltrami County Board approved the issuance of a \$40M bond to begin funding the first half of the \$80 million project. A second bond in the same amount will be issued later next year. The purpose for two bonds allows for flexibility in how the revenue from the sales tax is utilized in the debt repayment of the project. In the event interest rates adjust favorably for the County, refinancing or repayment of the bonds could save a significant amount of tax that would need to be collected and possibly early repayment of the bonds. Early repayment could also allow the sales tax to be retired early.

On March 19, 2024 the first bond was sold to Piper Sandler Companies after reviewing the nine municipal bids received. This followed a March 11 meeting where the County completed a bond rating interview with the S&P. The County performed well and achieved a “AA” rating (the highest rating possible) which backed the State’s “AAA” rating for credit enhancement. The premium came out better than expected. While maintaining \$40 million in proceeds from the sale, the bond was reduced to \$38,195,000. This will save \$332,400 in principle and interest payments over the life of the bond.

The Design and Operations Committee has been routinely meeting to ensure all aspects and needs of the new facility are addressed. Their work has allowed the County to move forward now that the design and development phase has been completed. It is of paramount importance to keep this project on schedule. The Finance Committee estimates that each month the project is delayed could cost the County over \$350,000 in inflationary and out of county housing costs. In April, the Board approved the timeline for construction to commence Spring of 2025. Winters can be challenging for construction and could have added an additional \$1M to the cost.

This project has been one of monumental planning with substantial input from many citizens, staff and elected officials. Accomplishing another milestone in this project shows the commitment of the County to ensure an adequate facility is constructed for the future needs while being as fiscally responsible as possible. The new jail will be constructed on donated land at the intersection of Railroad Street and Pioneer Street on the north side of the Bemidji Industrial Park.

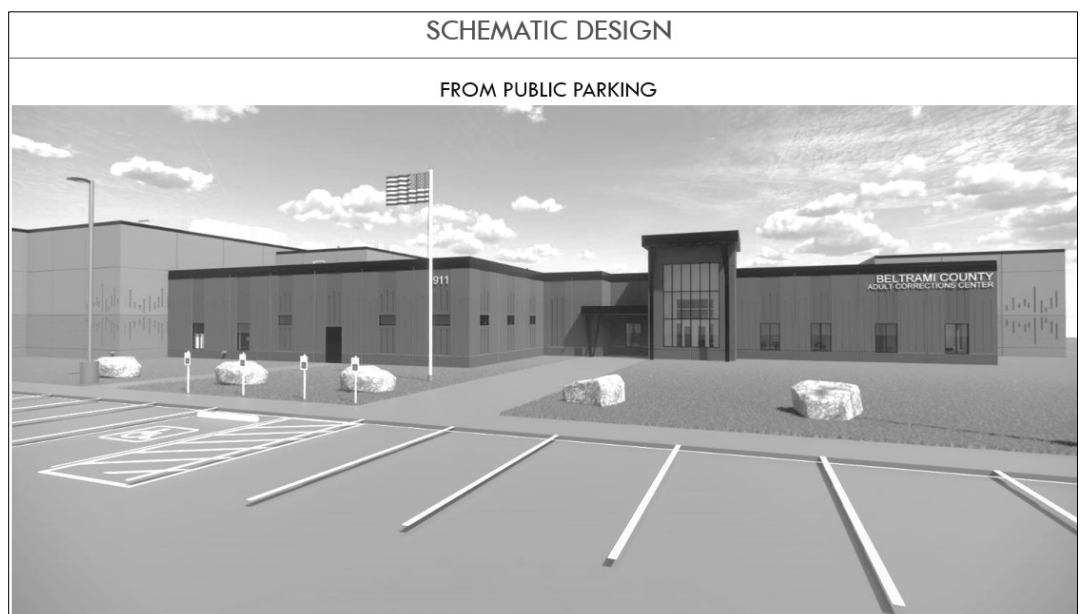

### What will Happen with the Current Jail?

We get a lot of questions about what the County intends to do with the existing jail. This is an important question which will be addressed in the near future. The focus at the current time is on getting the new jail designed and bid. Once that occurs, staff and consultants will turn their attention to the current facility. While there are many ideas about how to repurpose the current facility, the public must keep in mind that the facility’s type of construction (brick, concrete, steel bars, etc.), antiquated infrastructure, and deteriorating building systems may not lend itself to economical repurposing. The first step will be for the County to conduct a Building Condition & Feasibility Assessment. This will inform the County of the options and cost associated with repurposing the current jail. That work is slated to begin later in the fall.

*~submitted by: County Administrator, Tom Barry*

## Effective July 1, 2024

# New Sales and Use Tax

The Beltrami County Board of Commissioners held a public hearing on March 19, 2024 to enact a new Local Sales and Use Tax. With no public input received, the Board unanimously approved the ordinance imposing a five-eighths of one percent (0.625%) Local Sales and Use Tax to fund the construction of the new County Jail.

This was the final step the County Board was required to take to implement the new tax. This action follows legislative approval and a voter referendum on November 7, 2023 where Beltrami County voters approved the local sales and use tax as the preferred funding method for the new jail. The local sales and use tax is scheduled to become effective July 1, 2024 and will specifically finance the construction of a new, replacement jail facility together with modifications to the existing jail, as well as modifications to the current County Courthouse to accommodate the operational changes a new jail facility will impose as authorized by the Minnesota Legislature. It will also provide revenues to pay the MN Department of Revenue Commissioner the costs associated with collecting and administering the tax and also finance the administrative and financing costs related to the funding of the County's new jail.

Although it is a new tax, the local sales and use tax will reduce the financial impact to property taxpayers in Beltrami County over other options as it is estimated that approximately half of the sales tax collected will come from non-residents. The Sales and Use Tax was also found to be a more progressive funding source as essential and family staples such as food and clothing are exempted from the tax in addition to over 60 other goods and services (the full exemption list can be accessed here:

[www.revenue.state.mn.us/guide/nontaxable-sales](http://www.revenue.state.mn.us/guide/nontaxable-sales)). The tax is expected to be retired in either 30 years or when the full principal, interest and administrative revenues has been raised, whichever comes first.

Advancing the Jail Project has been a half-decades' long process for the County. The Minnesota Department of Corrections issued a Notice of Deficiency and required substantial investments in the current Beltrami County Jail effective September 30, 2019. Committed to mitigating these deficiencies, the Beltrami County Board of Commissioners issued a resolution to the Minnesota Department of Corrections in 2019 vowing to address the deficiencies and work towards long term solutions to address the growing population and increase in crime in our community. On November 15, 2022, the Beltrami County Board approved moving forward with the design and construction of a new jail facility, pending requisite process approvals and financing.

The new jail will be built on the north side of the Bemidji Industrial Park, meeting the State statutory requirement that a county jail be located within the county seat. The new facility will expand bed capacity, enhance safety for both inmates and staff, provide greater programming opportunities, comply with all MN Department of Corrections requirements, and decrease out of county housing costs. The County is planning for a groundbreaking ceremony later in the fall with major construction slated to begin in early spring of 2025. Once started, construction will take approximately two years to complete.

*~Submitted by: County Administrator, Tom Barry*

## 2024 Road Construction Projects

Summer brings road construction and for Beltrami County we have the following road improvement projects planned:

- CSAH 22, Turtle River Lake Rd, 2.2 miles SE of TH 71, bridge replacement
- CSAH 22, Turtle River Lake Rd, 0.5 miles W of CSAH 27, bridge replacement
- CSAH 57, Sandpiper Rd, Bittern Rd, and Island View Dr, from Sumac Rd to CSAH 21, bituminous surfacing
- CSAH 57, Island View Dr, from CSAH 21 to TH 71, resurfacing
- CSAH 6, 15<sup>th</sup> St NW, from CSAH 11 to Norton Ave, bituminous mill and overlay
- CSAH 21, Bemidji Rd, from Annebell St to TH 71, bituminous mill and overlay
- CSAH 8, Roosevelt Rd, from CSAH 25 to county line, bituminous mill and overlay
- CR 401, Monroe Ave, from CSAH 46 to CSAH 11, resurfacing
- CR 407, Sunnyside Rd, from CSAH 4 to CR 404, bituminous mill and overlay
- CR 407, Sunnyside Rd, from CR 404 to CSAH 8, resurfacing
- CSAH 12, Powerdam Rd, 0.7 miles W of CSAH 27, bridge/erosion repair

48 miles of chip seals are planned on the following routes:

- CSAH 12, Lake Ave, from 1<sup>st</sup> St to CSAH 19
- CSAH 15, Irvine Ave, from TH 197 to CSAH 52
- CSAH 15, Irvine Ave, from Turtle River xing to CSAH 32
- CSAH 19, Lake Ave, from CSAH 12 to Elliot Rd
- CSAH 20, Birchmont Beach Rd, from CR 414 to CSAH 27
- CSAH 30, Alwood Rd, from TH 71 to county line
- CSAH 39, Scenic Highway, from county line to CSAH 55
- CSAH 48, Beltrami Line Rd, from 1.5 miles E of CSAH 7 to CSAH 29
- CSAH 52, Anne St, from Minnkota Ave to CSAH 21
- CR 414, State Park Rd, from CSAH 20 to State Park

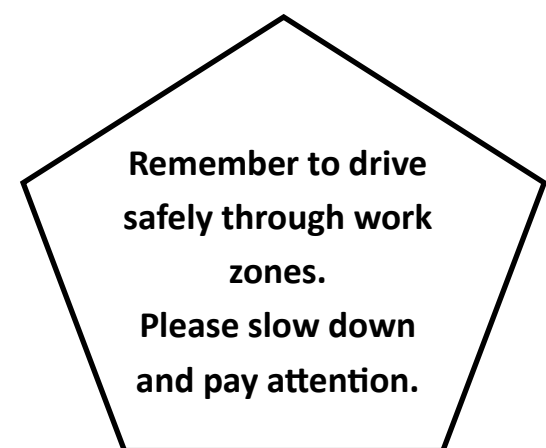

Stop in or call the Beltrami County Highway Department if you have questions or concerns.

2491 Adams Ave NW, Bemidji 218-333-8173

Additional maintenance projects are planned. One of the larger ones is drainage improvements along CR 507, Northwood Rd.

# Clip and Mail

Your opinion and feedback is important to us... tell us how you feel and return this clip to:

Beltrami County Administration

701 Minnesota Ave NW

Bemidji, MN 56601

OR e-mail to: [webmaster@co.beltrami.mn.us](mailto:webmaster@co.beltrami.mn.us)

1. Did you find the information in this Newsletter helpful?

2. What would you like to see in future issues of the Beltrami County News and Highlights?

3. A question I have of the County Board is:

4. A suggestion I have for the County Board is:



**Clip and Send**

## Low Level Radar Coverage Across MN

Following several significant weather events that impacted Minnesota, a group of Emergency Managers convened to further analyze the low-level radar coverage across the state. Emergency Managers have been aware for years the impacts low-level radar gaps have on storm warnings and how data is displayed on radar. Low-level radar gaps are the result of the radar beam being a straight line, not following the curvature of the Earth. The further away from a radar you are, the higher the beam is from the ground.

Bemidji, and much of Beltrami County, is in one of these radar gaps, located over 100 miles from both the Mayville, North Dakota and Duluth, Minnesota radars. This results in storm features approximately 10,000 feet and lower not clearly being picked up by the radar. Similar radar gaps are present in west-central Minnesota, northern Minnesota and along the Iowa border. Winter precipitation is routinely undetected by radar and even severe weather can go undetected. An example was the July 4, 2018 tornado that struck Bemidji without warning.

The Association of Minnesota Emergency Managers formed a radar gap committee to further research the issue. The committee developed public education campaigns on what radar gaps are as well as explored options to fill the gaps. One of the options being explored is state funding for additional radars. Additionally, the committee has been working on a public private partnership with a new business named Climavision. Using more, but smaller radars, these radars are able to get more eyes to the sky in these critical gap areas.

Climavision has successfully deployed a radar in Wendell, Minnesota in west-central Minnesota. The National Weather Service can access the data to augment their radar network and local emergency management officials have access as well. Climavision is working with other local government partners to identify existing infrastructure that can collocate with their radars. Four additional locations in Minnesota are proposed for 2024 installation, including one in Bemidji. The National Weather Service does an amazing job, and these additional radars will benefit public safety.

*~Submitted by: Emergency Management Director, Chris Muller*



## Welcome Kaleb Bessler, County Assessor

Hello, I'm Kaleb your new County Assessor!

I started in the real estate industry back when a purchase agreement was less than 10 pages long. That was 2005 and I was attending Bemidji State University. It was shortly after Facebook was launched, the 60th anniversary of D-Day and Kevin Garnett was still playing for the Timberwolves. I started out selling real estate, then appraising real estate and finally assessing it in 2011. I come to the position with an Associate's Degree in Business Administration from Bemidji State University and 15 years of Appraisal Experience: 2 years as a fee appraiser at Area Lakes Appraisals, 9 years as an assessor at Cass County and 4 years assessing here in Beltrami County. I have obtained an Accredited Minnesota Assessor license and am within striking distance of achieving my Senior Accredited MN Assessor Certification. I have been married to my wonderful wife for 17 years and we have three young children. I look forward to the opportunities to serve this community in the years to come.



# Public Health Programs and Services



## Opioid Settlement Funds

The Beltrami County Opioid Steering Committee meeting minutes, presentations, and education can be found on the County Web Site at [www.co.beltrami.mn.us](http://www.co.beltrami.mn.us),

choose Services - Public Health—Opioid Steering Committee. Under the direction of the Beltrami County Board of Commissioners, the Committee is releasing up to \$146,000 between five different community partners who submitted applications during the RFP process. The next steps for the committee include setting up the annual listening sessions and learning how the funding is making a positive impact in our community. If you would be interested in hosting a listening session or would like a presentation related to the committee and funding, please reach out to the Public Health Program Manager at 218-333-8152.

## Community Partnerships

Public Health has been working hard to continue to expand and build community partnerships by bringing services and support to the people we serve. We continue to serve as the regional Minnesota Diaper bank distribution site, we are completing our partnership to be the first location in the region to be a breastmilk donation site, and planning a community baby shower. If you have a Public Health concern or have questions for the department, you can contact us through our email or **Report a Health Concern** submittal on our website, Public Health page. If you would like to share your agency's gaps and talk about the possibility of a partnership, please reach out and let us know how we can best serve you and your organization.

## Working together with Emergency Management

Beltrami County Public Health completes several activities every year for Emergency Preparedness. Last year Beltrami County Emergency Preparedness and Emergency Management aligned, forming a partnership to address community needs, through strategically engaging with local and regional partners for training, management, and preparation for future emergency events. Strengthening relationships between Public Health and Emergency Management will lead to stronger community relationship building and collaboration that will ensure better health outcomes for Beltrami County and our neighboring communities. If you would like to learn more about Emergency Preparedness or Emergency Management, visit the Beltrami County Website at [www.co.beltrami.mn.us](http://www.co.beltrami.mn.us).

To get more involved or stay informed:

- Sign up for the EP News from MDH: [www.health.state.mn.us/about/org/epr/index.html](http://www.health.state.mn.us/about/org/epr/index.html)
- Make a plan and prepare your home, family, and friends: [www.health.state.mn.us/communities/ep/prepare.html](http://www.health.state.mn.us/communities/ep/prepare.html)
- To volunteer sign up at [www.mnresponds.org](http://www.mnresponds.org)
- Receive alerts from <https://public.coderedweb.com/CNE/en-US/6FAEC3D0EBD7>

Emergency Management Director 218-333-8386

Public Health Director/CHB Administrator 218-333-8116



~Submitted by: Amy Bowles, RN, BSN, MSN, PHN Public Health Division Director

# Housing Trust Fund

In August of 2023 the Beltrami County Board of Commissioners established the Beltrami County Housing Trust Fund to assist and enable lower income individuals to obtain and retain housing, and to encourage the development of housing stock for moderate, low and very low-income individuals.

Local Housing Trust Funds are used to dedicate revenue specifically for housing support and development and are designed to be a consistent, flexible resource for housing within a local jurisdiction. Trust funds help communities leverage public and private resources and jumpstart projects that draw investment and jobs. Local Housing Trust Funds enable communities to prioritize housing development, support and infrastructure that maximize benefit to the local community.

State funds were allocated to Beltrami County in support of local housing needs. The Beltrami County Board approved the funds allocated to Beltrami County from the Local Homeless Prevention Aid and the Statewide Affordable Housing Aid that was legislated to counties starting in July, 2023. These funds will provide seed money for the Beltrami County Housing Trust Fund.

<https://www.revenue.state.mn.us/local-homeless-prevention-aid>

<https://www.revenue.state.mn.us/statewide-affordable-housing-aid>

Per the state housing trust fund statute, a nonprofit entity can administer local housing trust funds. Beltrami County released a request for proposal (RFP) in late 2023 to secure an entity to administer the local trust. United

Way of the Bemidji Area was selected to administer the fund. The local United Way is in the beginning stages of planning for the release of applications to distribute funds from the Beltrami County Housing Trust Fund. The trust fund can support agencies or private business working to develop housing stock in Beltrami County for moderate, low and very low income households and/or for those same households to retain their housing.

Beltrami County anticipates the Beltrami County Housing Trust Fund will support creative efforts that combine funding streams resulting in larger impact to the housing needs of our area. As a trust fund, a variety of funding sources can be contributed. For more information on the Beltrami County Housing Trust Fund please reach out to:

Anne Lindseth  
[Anne.lindseth@co.beltrami.mn.us](mailto:Anne.lindseth@co.beltrami.mn.us)  
218-333-4195

OR

Halen Groenke  
[halen@unitedwaybemidji.org](mailto:halen@unitedwaybemidji.org)  
218-444-8929



United Way  
of Bemidji Area



## Water Safety Measures in Beltrami County

Beltrami County's miles of rivers and dozens of lakes make it a popular destination for those wanting to enjoy boating, fishing, swimming and water skiing. The State of Minnesota and Beltrami County continually evaluates and upgrades facilities such as public beaches, boat ramps and waterfront parks to enhance accessibility and safety. As summer approaches and residents and visitors flock to enjoy aquatic activities, it's crucial to prioritize safety measures to prevent accidents and protect lives. One of the most effective ways to enhance water safety is through education.

Promoting a culture of vigilance and accountability plays a crucial role in preventing water-related accidents. Whether boating, swimming, or engaging in water sports, individuals must prioritize safety at all times. This includes adhering to designated swimming areas, obeying boating regulations, and refraining from risky behaviors such as consuming alcohol while on the water. It's important to know what hazards may be present before hitting the water, such as drop-offs, currents and submerged obstacles. Individuals engaging in water activities should always have a plan in place, in-

cluding informing others of their whereabouts and expected return time. Carrying essential safety equipment, such as life jackets, first aid kits and communication devices can mitigate risks.

Investments in infrastructure and emergency response capabilities are also essential components of ensuring water safety. Beltrami County's emergency services, including the Sheriff's Office and other first responders, collaborate by conducting training and exercises on water emergencies. Water safety in Beltrami County is a shared responsibility that requires proactive measures, education, and community engagement. By fostering a culture of awareness, preparedness, and accountability, residents and visitors can enjoy the county's picturesque waterways while minimizing the risk of accidents and ensuring the safety of all who venture into its waters. Be aware of your surroundings and keep track of children when near water.

Remember, when it comes to water safety, vigilance saves lives.

*~Submitted by: Sheriff Jason Riggs*

## Asset Verification Now Required for MHCP Applicants and Enrollees

As Minnesota unwinds from the public health emergency waivers, individuals who are part of the MHCP (which includes Medical Assistance, MinnesotaCare, Minnesota Family Planning Program, Home and community-based waiver programs and the Medicare Savings Program) will once again be required to verify their assets when they renew their MHCP coverage and for new applications. This change specifically affects our county residents currently enrolled or who will apply that meet the following conditions: **age 65 or older**, **blind**, or have a **disability**.

### Asset Verification:

Income and assets must be verified at application, renewal and when a change in circumstance is reported for our MHCP county residents who are age 65 or older, are blind or who have a disability. If you applied or will renew your medical assistance coverage after **March 31, 2023**, asset verification may be necessary. Please ensure that a completed **DHS Form 7823** (Authorization to Obtain Financial Information) is submitted with your application or renewal to allow Beltrami County to verify assets electronically.

Some assets do not require annual verification: Vehicles unlikely to increase in value that were previously verified. Assets previously verified through the Social Security Administration for Supplemental Security Income recipients. However, assets that increase in value or become available, such as life insurance policies may become countable.

### Income Verification:

Individuals must report the type, amount, and frequency of income at application, renewal, and when their income changes. This verification must occur before Beltrami County can make an eligibility determination. We will attempt to verify an individual's income and assets through reliable electronic data sources before requesting verifications from an applicant. If we cannot verify income and assets, we will ask the individual to provide proof before we can determine healthcare eligibility. If an individual needs assistance in obtaining proofs of income from an employer, a completed **DHS Form 2146** (Authorization for Release of Employment Information) must be turned in to allow Beltrami County to reach out to the employer on the individual's behalf.

Understanding the above changes will assist individuals in reducing processing times and helping ensure an accurate healthcare eligibility determination. Beltrami County is committed to assisting applicants and enrollees throughout this process. If you have any questions or need assistance, please visit the official website at <https://mn.gov/dhs> or contact the agency directly at 218-333-8300.

MHCP Programs with Asset and Income Limits:
<b>Medical Assistance for People Age 65 or Older, Blind, or with a Disability (MA-ABD)</b>
<b>Medical Assistance for Parents or Caretaker Relatives with a Spenddown</b>
<b>Medical Assistance for Long-Term Care Services (MA-LTC)</b>
<b>Medicare Savings Programs (MSP):</b> Qualified Medicare Beneficiaries (QMB), Service Limited Medicare Beneficiaries (SLMB), Qualified Individuals (QI), Qualified Working Disabled (QWD)
<b>Emergency Medical Assistance (EMA)</b> under an MA-ABD basis.
Income and Asset limits can be found by searching for Income and Assets at <a href="https://mn.gov/dhs">https://mn.gov/dhs</a> .

# 2024 Redistricting

A Court appointed Redistricting Commission has completed their charge of formulating and certifying to the Court a redistricting plan for Beltrami County in light of the 2020 Federal Census. The Plan has been accepted by the Court.

The Redistricting Commission held four work sessions and three public hearing to review and consider options for Beltrami County Commissioner Districts. The Commission considered all maps previously presented in addition to maps that were presented during the public hearings. The Commission, by majority, ultimately decided on Map 5C.

Townships and Cities are represented by Commissioner Districts as follows:

**Commission District 1**  
 Bemidji City Ward 5  
 Birch Township  
 Brook Lake Unorganized #3  
 Frohn Township  
 Hagali Township  
 Moose Lake Township  
 Port Hope Township  
 Sugar Bush Township  
 Taylor Township  
 Ten Lake Township  
 City of Tenstrike  
 City of Turtle River  
 Turtle River Township

**Commissioner District 2**  
 Bemidji City Ward 1  
 Bemidji City Ward 2  
 Bemidji City Ward 4

**Commissioner District 3**  
 Bemidji Township  
 Buzzle Township  
 Eckles Township  
 Grant Valley Township  
 Jones Township  
 Lammers Township  
 Maple Ridge Township  
 Roosevelt Township  
 City of Solway  
 City of Wilton

**Commissioner District 4**

Alaska Township	O'Brien Township
Battle Township	City of Ponemah
Benville Township	Quiring Township
City of Blackduck	City of Red Lake
Cormant Township	City of Redby
City of Funkley	Shooks Township
Hamre Township	Shotley Township
Hines Township	Spruce Grove Township
Hornet Township	Steenerson Township
City of Kelliher	Summit Township
Kelliher Township	Upper Red Lake Unorganized #2
Langor Township	Waskish Township
Lee Township	Woodrow Township
City of Little Rock	
Minnie Township	
North Beltrami Unorganized #1	

**Commissioner District 5**  
 Bemidji City Ward 3  
 Durand Township  
 Liberty Township  
 Nebish Township  
 Northern Township  
 Turtle Lake Township

Commissioners can be contacted by phone or e-mail:

**District 1 Commissioner Craig Gaasvig**

218-766-9699

cgaasvig@paulbunyan.net

**District 2 Commissioner Joe Gould**

218-259-4342

Joe.gould@co.beltrami.mn.us

**District 3 Commissioner Richard Anderson**

218-467-3275

richard@paulbunyan.net

**District 4 Commissioner Tim Sumner**

218-407-7589

timsumner15@gmail.com

**District 5 Commissioner John Carlson**

218-766-5010

John.carlson@co.beltrami.mn.us

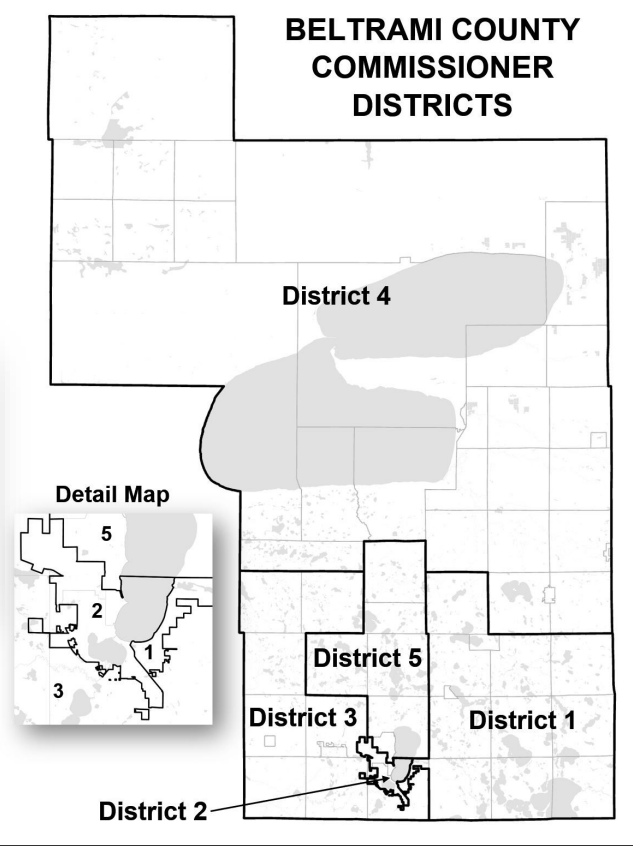

For additional information and detail, visit the County Board of Commissioners at [www.co.beltrami.mn.us/Government/Board\\_of\\_Commissioners.html](http://www.co.beltrami.mn.us/Government/Board_of_Commissioners.html)

~Submitted by: JoDee Treat, Auditor-Treasurer

## Beltrami County Career Opportunities

Working for Beltrami County provides more than just a job, it offers a fulfilling career and a chance to make a difference in our community. We offer a variety of employment opportunities across different departments which creates an assortment of possibilities to find a position that is perfect for you.

Besides gaining a rewarding career in local government, Beltrami County provides comprehensive benefits, retirement plans, and paid time off. We also provide on the job training where every employee has the chance to contribute their unique skills and abilities.

We invite you to explore our current job openings. You can find us on Facebook (@BeltramiCountyHumanResources) or LinkedIn (@BeltramiCounty) to keep tabs on our open careers. To apply, visit our career webpage ([governmentjobs.com/careers/beltramimn](http://governmentjobs.com/careers/beltramimn)).

By joining our team, you will play an integral role in the future of our county and improving the quality of services for all residents.

~Submitted by: Ann Schroeder, Human Resources Director

Beltrami County Public Health

# Open House

**WELCOME TO OUR NEWLY REMODELED CLINIC**  
**June 24th, 2024**  
**11:30 AM-1:30 PM**

Join us in celebrating our remodeled clinic as well as WIC's 50th anniversary!

Stop by for refreshments and snacks. Meet our staff, learn about our services, and tour our new clinic!

616 America Ave NW - Suite 130  
 Bemidji, MN 56601

## Beltrami County Solid Waste

# Storage of Waste on Individual Properties

2024 Redistricting	Congressional District #8	State Senate District #2	State House District #2A	State House District #2B	Beltrami Commissioner District
Alaska Township	X	X	X		4
Battle Township	X	X	X		4
Bemidji City Ward 1	X	X	X		2
Bemidji City Ward 2	X	X	X		2
Bemidji City Ward 3	X	X	X		5
Bemidji City Ward 4	X	X	X		2
Bemidji City Ward 5	X	X	X		1
Bemidji Township	X	X	X		3
Benville Township	X	X	X		4
Birch Township	X	X		X	1
Blackduck City	X	X		X	4
Brook Lake Unorganized #3	X	X		X	1
Buzzle Township	X	X	X		3
Cormant Township	X	X		X	4
Durand Township	X	X	X		5
Eckles Township	X	X	X		3
Frohn Township	X	X		X	1
Funkley City	X	X		X	4
Grant Valley Township	X	X	X		3
Hagali Township	X	X		X	1
Hamre Township	X	X	X		4
Hines Township	X	X		X	4
Hornet Township	X	X		X	4
Jones Township	X	X	X		3
Kelliher City	X	X		X	4
Kelliher Township	X	X		X	4
Lammers Township	X	X	X		3
Langor Township	X	X		X	4
Lee Township	X	X	X		4
Liberty Township	X	X	X		5
Little Rock	X	X	X		4
Maple Ridge Township	X	X	X		3
Minnie Township	X	X	X		4
Moose Lake Township	X	X		X	1
Nebish Township	X	X	X		5
North Beltrami Unorganized #1	X	X	X		4
Northern Township	X	X	X		5
O'Brien Township	X	X		X	4
Ponemah	X	X	X		4
Port Hope Township	X	X		X	1
Quiring Township	X	X	X		4
Redby	X	X	X		4
Red Lake	X	X	X		4
Roosevelt Township	X	X	X		3
Shooks Township	X	X		X	4
Shotley Township	X	X	X		4
Solway City	X	X	X		3
Spruce Grove Township	X	X	X		4
Steenerson Township	X	X	X		4
Sugar Bush Township	X	X		X	1
Summit Township	X	X		X	4
Taylor Township	X	X		X	1
Ten Lake Township	X	X		X	1
Tenstrike City	X	X		X	1
Turtle Lake Township	X	X	X		5
Turtle River City	X	X		X	1
Turtle River Township	X	X		X	1
Upper Red Lake Unorganized #2	X	X	X		4
Waskish Township	X	X	X		4
Wilton City	X	X	X		3
Woodrow Township	X	X		X	4

This office receives several calls, or inquires regarding their neighbor's property. If you believe your neighbor's property is unsightly you need to start with notifying your township officials to ask for their help. If the elected township officials decide to take action the township must write a letter to the Solid Waste Department requesting help, and recommended action. The Solid Waste Committee will review all township requests and decide what action will be taken. Exhibit B: Solid Waste Site Violation Flow Chart can be found in the Solid Waste Ordinance 13. The Ordinance is available on the Beltrami County Website.

Property owners and managers shall maintain their open areas free of Solid Waste accumulations unless the solid waste is stored in an acceptable container as specified in this Ordinance, to preclude the development of vectors, and odors, or become Public Health Nuisance. Ref: Minn. Rules 7035.0700, and 7035.2855.

The owner, lessee and occupant of any premises, business establishment or industry shall be responsible for the satisfactory storage of all solid waste accumulated at that premise, business establishment, or industry. No building, structure, area, or premise shall be constructed or maintained for human occupancy, use, or assembly without adequate facilities for sanitary and safe storage, collection, transportation, and disposal of all solid wastes.

Putrescible waste, including but not limited to garbage, shall be stored in:

- durable, rust-resistant, non-absorbent, water-tight, rodent-proof, easily cleanable containers with close-fitting, fly-tight covers, and having adequate handles to facilitate handling, or
- Other types of containers acceptable to the solid waste collection service, in compliance with pertinent statutes, Agency regulations, and approved by the Solid Waste Administrator. The size and allowable weight of the containers may be determined by the solid waste collection service as approved by the Solid Waste Administrator.
- Solid waste shall be stored in durable containers or as otherwise provided in this ordinance. Where putrescible wastes are stored in combination with non-putrescible wastes, containers for the storage of the mixture shall meet the requirements for putrescible waste containers.
- Toxic or hazardous wastes shall be stored in durable, leak-proof containers which are labeled with a description of the chemical composition of them substance stored therein. Such wastes shall be stored in a safe location and in compliance with the requirements of pertinent statutes, Agency regulations, and this ordinance.
- Solid waste objects or materials too large or otherwise unsuitable for storage containers shall be stored in a manner which is pollution-free, nuisance-free, and satisfactory to the Solid Waste Administrator.
- All storage of solid waste shall conform to all pertinent statutes and Agency regulations. Nothing in this section shall be construed to permit non-compliance with those statutes and regulations.

A copy of the Solid Waste Ordinance #13 can be found on the Beltrami County Website at [www.co.beltrami.mn.us](http://www.co.beltrami.mn.us), under Business & Development—Ordinances.

*~Submitted by: Brian Olson, Solid Waste Division Director*

### NEW SOLID WASTE SERVICE—Beginning June 1

The Bemidji Transfer Station will accept Leaves and Grass clippings **if the Demolition Landfill is Closed.** See the website for all facilities hours: <https://www.co.beltrami.mn.us/living-here/garbage-and-recycling/#>

Leaves/Grass must be bagged, or in a durable container so the contents can be emptied in the number 2 compactor, located in the left/north lane. Only leaves/grass in the compactor no bags/containers/or Garbage. Signs will be posted inside the Transfer Station.

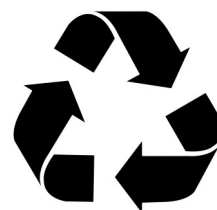

2

**LEAVES / GRASS TRIMMINGS**

- Only available when Landfill is not.
- Bagged leaves/trimmings must be dumped, and bags put in can provided.

• No Garbage

# Workforce Impact

## Making a Difference in Beltrami County

Over the past few months, our dedicated team of Navigators and Business Account Representatives have been actively engaging with our community. Whether you've heard us on the radio or seen us on television, our current events at the CSC Building have made an impact to those in Beltrami County.

Our efforts have been multifaceted. In March, we hosted the inaugural First Responders Hiring Event, connecting local heroes with employment opportunities. Then, in April, we organized the first annual WorkForce Impact and Downtown CareerForce Open House, providing a platform for job seekers, employers, and partnering agencies to connect.

Our mission is clear: to make our services known to the community. The recent Open House was a resounding success, allowing us to network with other businesses and agencies in Beltrami County. We received valuable referral information and had the opportunity to educate others on how interconnected we all are when it comes to assisting our residents.

But our commitment extends beyond these events. We consistently participate in community initiatives such as the Chamber of Commerce and the United Way, always seeking to refresh our knowledge of local resources and discover new ones that can benefit the clients we serve in the Economic Assistance Division. It's not just about gathering information; we roll up our sleeves and actively assist those in need. For instance, when individuals faced immediate displacement from their homes due to vacate notices, our helpful team stepped in to facilitate food deliveries to hotels around the Bemidji Area by assisting our partnering agencies.

A Bright Future Ahead: Hold onto your hats, Beltrami County! Our Supported Worker is on the cusp of a remarkable opportunity. The Science Center is seriously considering hiring them on in the upcoming months. This potential match promises to be a win-win for both the worker and business. Stay tuned as we continue to champion self-sufficiency and build stronger connections within our community. Remember, that together, we are "Keeping Beltrami County Working."

*~Submitted by: Dave Wall, Employment Services Supervisor*



### BELTRAMI COUNTY WORKFORCE IMPACT



**Dave Wall**  
Supervisor



**Chad Schroth**  
Team Lead



**Amy Mystic**  
Business Account Rep



**Jerika Christiansen**  
Navigator



**Amber Asplund**  
Navigator



**Cassie Tryon**  
Navigator



**Lauren Haun**  
Navigator



# WORKFORCE IMPACT

*Keeping Beltrami County Working*

[www.co.beltrami.mn.us](http://www.co.beltrami.mn.us)

#### Board of Commissioners

- District 1—Craig Gaasvig .....218-766-9699
- District 2—Joe Gould .....218-259-4342
- District 3—Richard Anderson .....218-467-3275
- District 4—Tim Sumner .....218-407-7589
- District 5—John Carlson .....218-766-5010

#### Administration Building

701 Minnesota Ave NW, Bemidji MN 56601

- Administrator—Thomas Barry ..... 218- 333-4109
- Assessor—Kaleb Bessler .....218-333-4116
- Auditor/Treasurer—JoDee Treat.....218-333-4175
- Environmental Services—Brent Rud .....218-333-4158
- Facilities Manager—Steve Shadrick .....218-333-8475
- Geographic Info Systems (GIS).Kevin T. 218-333-8457
- Human Resources—Ann Schroeder .....218-333-4155
- License Center .....218-333-4148
- Mgmt Info Systems (MIS)—Kevin W. ... 218-333-4151
- Natural Resource Mgmt—Dick Moore ..218-333-4210
- Real Estate & Tax Services.....218-333-4138
- Recorder—Charlene Sturk.....218-333-4170

#### Community Service Center

616 America Ave NW, Bemidji MN 56601

- Health & Human Services—Director Anne Lindseth
- Social Services - Director Jeff Lind .....218-333-4196
- Economic Assistance Division
- Director—Curt Anderson.....218-333-2242
- Public Health - Director Amy Bowles.... 218-333-8140
- Veterans Services Shane Gustafson 218-333-4177

#### Law Enforcement Center

613 Minnesota Ave NW, Bemidji MN 56601

- Sheriff Jason Riggs .....218-333-9111
- Bemidji Police Chief Mike Mastin.....218-333-9111

#### Judicial Center

600 Minnesota Ave NW, Bemidji MN 56601

- Attorney—David Hanson.....218-333-4219
- Court Administration.....218-333-4120

#### County Jail

626 Minnesota Ave NW, Bemidji MN 56601

- Main phone number.....218-333-4189

#### Public Works Department

2491 Adams Ave NW, Bemidji MN 56601

- Highway Engineer—Bruce Hasbargen...218-333-8173
- 751 Industrial Park Dr SE
- Solid Waste Director—Brian Olson .....218-333-8187

#### County Extension

7223 Fairgrounds Rd NW, Bemidji MN 56601

- Extension Secretary .....218-444-5722